



# Pre-Alert Sensor Pad

A Real Fall Prevention System



- A NEW patented multi-zone detection design effectively shortens alarm time in the event of bed exit
- Alarm will be triggered once the patient intends to get off the bed
- Provides caregiver more time to respond and reduce potential falls
- "Pre-Alert" zone will trigger the alarm immediately if patient sitting on the zone (bed side)
- "Low False Alarm" zone with 3 seconds delay default setting, will greatly help reduce the number of false alarms
- Anti-microbial surface with care instructions printed at the back of pad
- Cordless design, no cable between pad and monitor

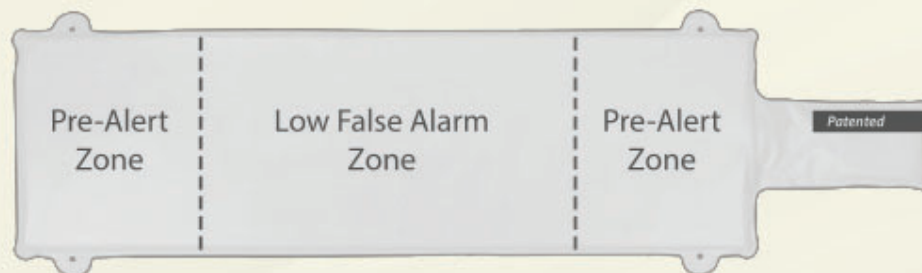

Pre-Alert Sensor Pad

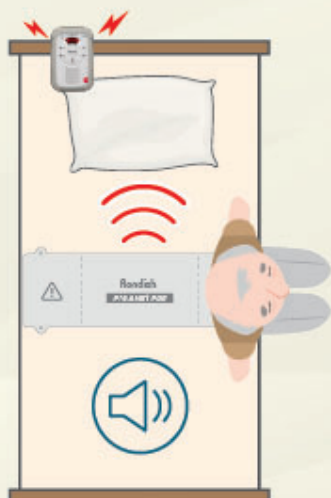

Alarm will be triggered immediately when sitting right on "Pre-Alert" zone



3 seconds delay on "Low False Alarm" zone, greatly reduce false alarms

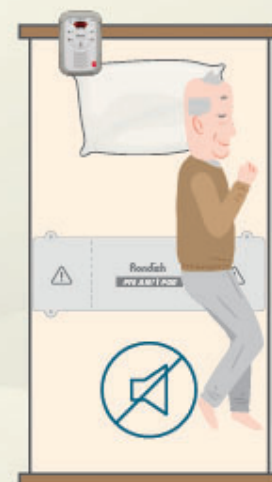

No alarm if sleeping on both zone of "Pre-Alert" and "Low False Alarm". Alarm will be triggered immediately if leaving both zones



**RONDISH COMPANY LIMITED**  
Tel.: (852) 2541 6685  
Email: sales@rondish.com  
Website: www.rondish.com



30 Years of Experience  
in Healthcare Security Industry



**Rondish**